

|               |                                       |
|---------------|---------------------------------------|
| <b>(a)</b> 1x | Calha nº95<br>Track nº95<br>Rail nº95 |
| <b>(b)</b> 2x | Ref. 5001                             |
| <b>(c)</b> 2x | Ref. 3005                             |
| <b>(d)</b> *  | Ref. 6003<br>50x30                    |
| <b>(e)</b> 2x | Ref. 4005                             |
| <b>(f)</b> 1x | Ref. 7017                             |
| <b>(g)</b> *  | 4X40mm M6x30                          |
| <b>(h)</b> *  | M5x12                                 |

**Fixa o travão à calha**  
Fixate the brake to the track  
Fixation du frein au rail

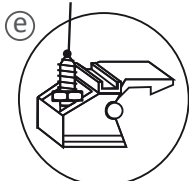

**Rasgo para porta**  
Door tearing  
Rainure de la porte

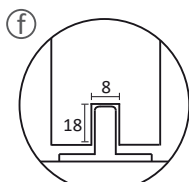

**Aplicação de Perfil PVC (opcional)**  
Profile PVC (optional)  
Application du profil en PVC (optionnel)

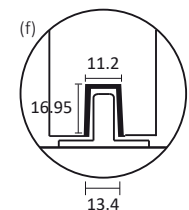

**ATENÇÃO | ATTENTION | ATENTION**

**Parafuso de suporte | Support hinge | Vis de support**

A porca só é apertada depois de a porta estar suspensa e ajustada nos rodízios.

The nut should only be tight after the door is suspended and adjusted on the trolleys.

L'écrou est serré qu'après la porte être suspendu et fixé aux chariots.

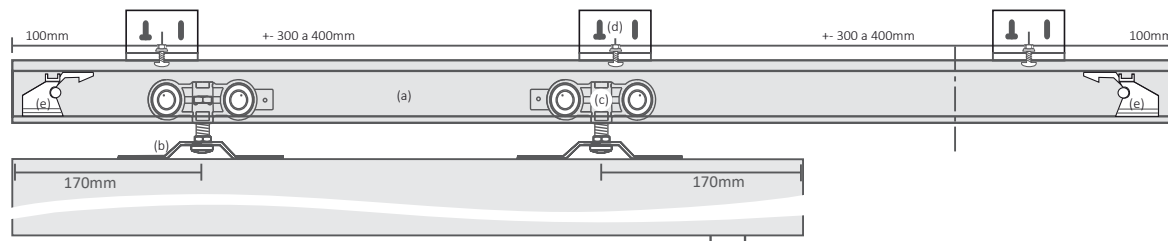

**Legenda:**  
H - Altura do vão | Opening height | Hauteur passage  
HF - Altura da furação | Drilling height | Hauteur perçage

HP - Altura da porta | Door height | Hauteur porte  
L - Largura do vão | Opening width | Largeur passage  
LP - Largura da porta | Door width | Largeur de la porte

**DESENHO TÉCNICO**  
TECHNICAL DRAWING | DESSIN TECHNIQUE

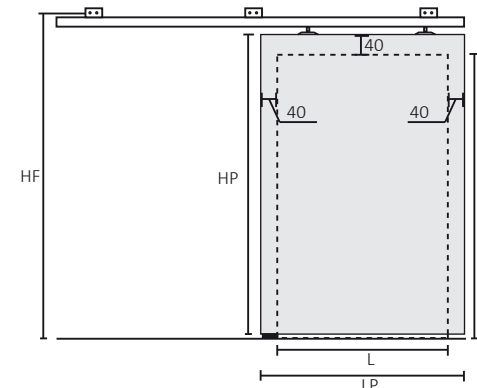

**Fixação ao teto**  
Ceiling fixation  
Fixation au plafond

Cálculo | Calculation | Calcul

- **Altura da porta**  
Door height  
Hauteur de la porte  
HP = H - 71
- **Largura da porta**  
Door width  
Largeur porte  
LP = L + 80

**Fixação à parede**  
Wall fixation  
Fixation au mur

Cálculo | Calculation | Calcul

- **Furação | Drilling | Perçage**  
HF = H + 126
- **Altura da porta**  
Door height  
Hauteur de la porte  
HP = H + 35
- **Largura da porta**  
Door width  
Largeur porte  
LP = L + 80

